

LOAD CELLS: MODEL: ALD-UTC

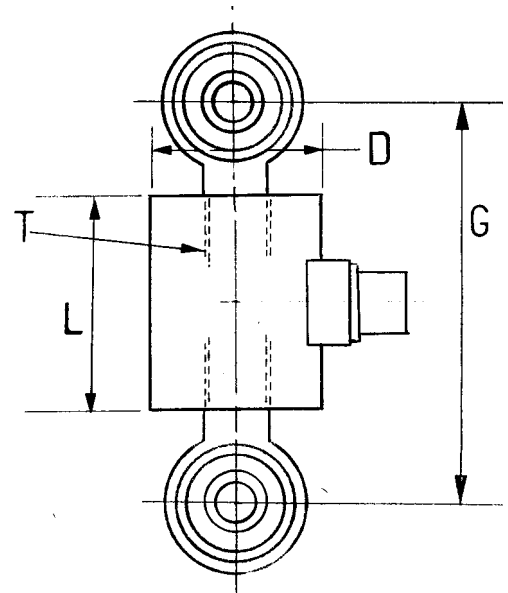

The ALD-LOAD CELLS are compact reliable sensors designed for accurate and repeatable measurements of static and dynamic loads.

Electrically this Load Cell is a full WHEATSTONE BRIDGE with four arms. The strain sensitive elements are bonded to the load column and are sealed with a moisture proof coating to shield them from harsh environment.



SPECIFICATIONS:

Output Resistance:	350Ω (Nominal) 750Ω bridge 20,000 lb (10,000 Kg) & larger
Input Resistance:	350Ω (Nominal) 750Ω bridge 20,000 lb (10,000 Kg) & larger
Excitation:	10 VDC or AC
Sensitivity:	2 mV/V (Nominal)
Non-linearity:	±0.15% F.S.
Hysteresis:	±0.15% F.S.
Comp. Temp. Range:	15°F to 150°F (-10°C to 65°C)
Safe Overload:	150% Rated Capacity
Ultimate Overload:	150% Rated Capacity
Zero Balance:	Better than 1% F.S.

SPECIAL OPTIONS: THIS UNIT MAY BE ORDERED WITH ± 10V OUTPUT. REQUIRES ± 15 VDC EXCITATION

Model Number	Capacity		G Nominal	D	T	L
	lb	Kg				
ALD-UTC 500-A	500	250	4.75" / 120.65mm	2" / 50.8mm	¾-16 / m20x2.5	2.50" / 63.5mm
ALD-UTC 1000-A	1000	500	4.75" / 120.65mm	2" / 50.8mm	¾-16 / m20x2.5	2.50" / 63.5mm
ALD-UTC 2000-A	2000	1000	4.75" / 120.65mm	2" / 50.8mm	¾-16 / m20x2.5	2.50" / 63.5mm
ALD-UTC 3000-A	3000	1500	4.75" / 120.65mm	2" / 50.8mm	¾-16 / m20x2.5	2.50" / 63.5mm
ALD-UTC 5000-A	5000	2500	4.75" / 120.65mm	2" / 50.8mm	¾-16 / m20x2.5	2.50" / 63.5mm
ALD-UTC 5000-B	5000	2500	8.0" / 203.2mm	2" / 50.8mm	¾-16 / m20x2.5	4.5" / 114.3mm
ALD-UTC 10,000-B	10,000	5000	8.0" / 203.2mm	2" / 50.8mm	¾-16 / m20x2.5	4.5" / 114.3mm
ALD-UTC 15,000-B	15,000	7500	10.0" / 254mm	2" / 50.8mm	1¼-12 / m33x3.5	5.0" / 127mm
ALD-UTC 20,000-B	20,000	10,000	10.0" / 254mm	2" / 50.8mm	1¼-12 / m33x3.5	5.0" / 127mm
ALD-UTC 30,000-B	30,000	15,000	18.4" / 467.36mm	3.5" / 88.4mm	1¼-12 / m33x3.5	8.0" / 203.2mm
ALD-UTC 40,000-B	40,000	20,000	20.5" / 520.7mm	3.5" / 88.4mm	1¼-12 / m33x3.5	8.0" / 203.2mm
ALD-UTC 50,000-B	50,000	25,000	20.5" / 520.7mm	3.5" / 88.4mm	1¼-12 / m39x4	8.0" / 203.2mm

A.L. Design, Inc.

1411 Military Road • Buffalo, NY 14217-1395
 Phone (716) 875-6240 • Fax (716) 875-2404
<http://www.aldesigninc.com>